

# Soils Map

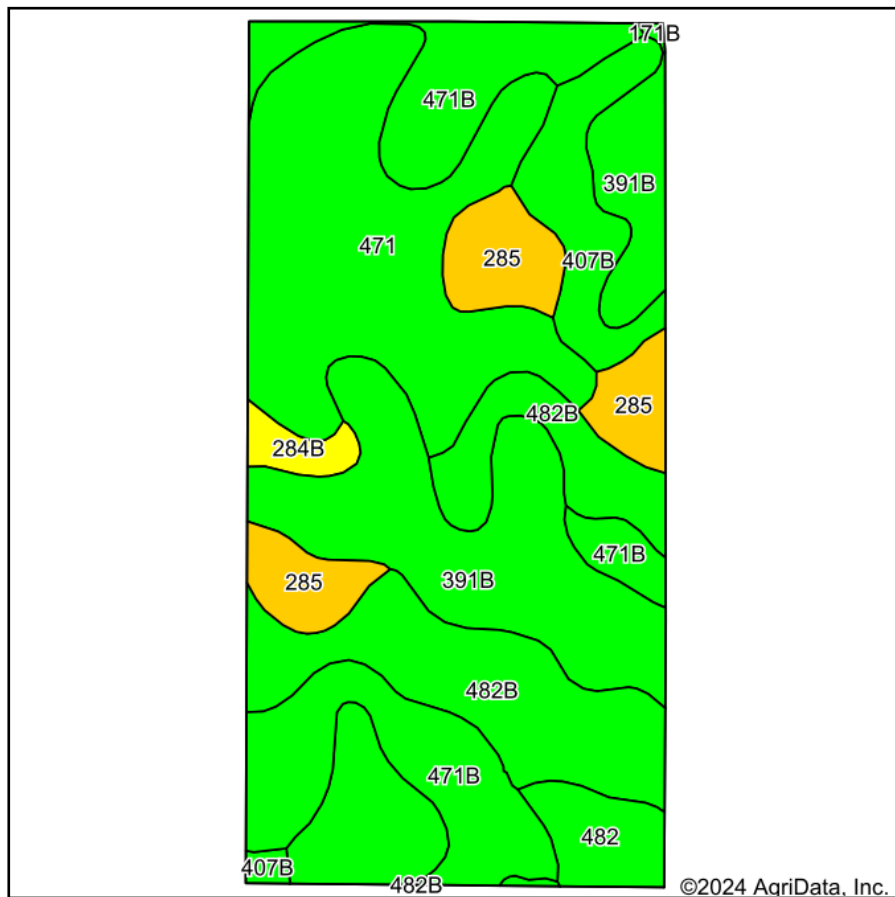

Soils data provided by USDA and NRCS.

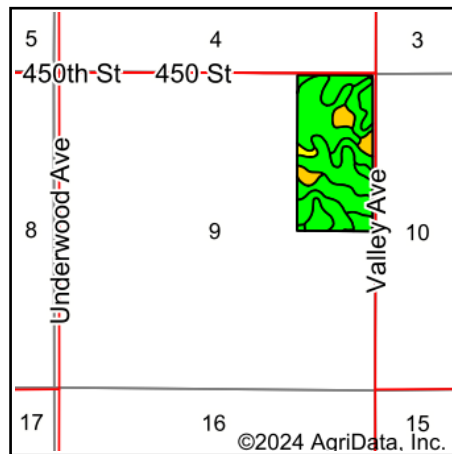

State: **Iowa**  
 County: **Mitchell**  
 Location: **9-99N-15W**  
 Township: **Jenkins**  
 Acres: **75.55**  
 Date: **5/31/2024**

**MIDWEST LAND** & REAL ESTATE, INC.  
 712-262-3110 **MANAGEMENT**

Maps Provided By:  
  
 CUSTOMIZED ONLINE MAPPING  
 © AgriData, Inc. 2023 www.AgriDataInc.com



Area Symbol: IA131, Soil Area Version: 29

Code	Soil Description	Acres	Percent of field	CSR2 Legend	CSR2**	CSR
391B	Clyde-Floyd complex, 1 to 4 percent slopes	18.58	24.5%		87	75
471	Oran loam, 0 to 2 percent slopes	17.42	23.1%		79	83
471B	Oran loam, 2 to 5 percent slopes	13.21	17.5%		74	78
482B	Racine loam, 2 to 5 percent slopes	12.29	16.3%		76	78
285	Burkhardt sandy loam, 0 to 3 percent slopes	5.91	7.8%		17	30
407B	Schley silt loam, 1 to 4 percent slopes	4.68	6.2%		81	73
482	Racine silt loam, 0 to 2 percent slopes	2.34	3.1%		87	83
284B	Flagler sandy loam, 2 to 5 percent slopes	1.04	1.4%		51	40
171B	Bassett loam, 2 to 5 percent slopes	0.08	0.1%		85	78
Weighted Average					74.7	74

\*\*IA has updated the CSR values for each county to CSR2.